

Nigel Brooke

**APPLICATION FROM THE QUEENS HEAD IN
WING UNDER THE LICENSING ACT 2003 FOR
CONVERSION AND VARIATION OF
PREMISES LICENCE**

Local Member: Councillor Mrs N Glover

1. THE APPLICATION

Applicant(s): **Punch Taverns Plc**

Premises: **The Queens Head,
9 High Street,
Wing,
Leighton Buzzard
LU7 0NS**

1.1 Conversion Application

No representations have been received from Thames Valley Police in respect to the application by the Queens Head in Wing to convert the existing permissions to a Premises Licence. Therefore in accordance with the transitional provisions of the Licensing Act 2003 the application to convert the existing permissions, namely, a justices' licence, must be granted subject to any existing statutory restrictions and conditions and any other conditions which currently apply. In respect to the limitation on hours, this would permit the premises to sell alcohol during the following hours:

Monday to Saturday 11.00 a.m. to 11.00 p.m.
Sunday 12.00 mid-day to 10.30 p.m.

Attached as Appendix 1 is a copy of the completed application form, the designated premises supervisor consent form and a copy of the justices' licence. A plan of the premises will be made available at the Sub-Committee hearing.

1.2 Variation application

The application is for the variation of the Premises Licence during the transitional period under Schedule 8, paragraph 7 (1)(b) of the Act. More specifically, the application relates to the extension of the terminal hour and the provision of regulated entertainment, namely live and recorded music, as an additional licensable activity, as follows:

Monday to Saturday 10.00 a.m. to 12.00 mid-night
Sunday 11.00 a.m. to 11.30 p.m.

In addition the application is for the following non standard timings:

- A further additional hour into the morning following every Friday, Saturday, Sunday and Monday for each May Bank Holiday, Spring/Whitsun Bank Holiday and every August Bank Holiday weekend
- A further additional hour into the morning following every Thursday, Friday, Saturday, Sunday and Monday for the Easter Bank Holiday
- A further additional hour every Christmas Eve
- A further additional hour every Boxing Day
- To reflect existing New Year's Eve/ day hours

The application also asks for an additional 30 minutes on the terminal hours described above that the premises are open to the public.

The proposed designated premises supervisor is Denise Joy Redding and the steps the applicant intends to take to promote the licensing objectives are set out in the operating schedule (see appendix 1, page 23 of application form).

2. RELEVANT REPRESENTATIONS

2.1 Responsible Authorities

Thames Valley Police – No objection
Bucks Fire and Rescue – No comment
Environmental Health – No objection
Planning – No objection
Trading Standards – No comment
Area Child Protection Committee – No comment

2.2 Interested Parties

2.2.1 Miss N McKernion – 11 High Street, Wing

Miss McKernion is concerned about the effect of including karaoke and live music on the licence on her home life and the potential sale of her property. Miss McKernion's representation is attached as Appendix 2.

2.2.2 Mr K Kavan – 11 High Street, Wing

Mr Kavan is not overtly concerned with the change of hours but more over the provision of musical performances. Mr Kavan is particularly worried as his property and the Queens Head share a party wall. Mr Kavan's representation is attached as Appendix 3.

3. REQUESTS FOR PERMISSION TO CALL WITNESSES

All parties were served Notices of Hearing on the 19 May 2005 along with the document, 'Licensing Act 2003 – The Procedure to be followed at Hearings'. A copy of this document will be available to the Sub-Committee at the hearing. At

the time of writing this report no requests have been made for permission to call witnesses.

4. REQUESTS FOR CLARIFICATION AT THE HEARING FROM A PARTY

At the time of writing this report no requests for clarification have been made.

5. STATEMENT OF LICENSING POLICY

The following references are to the Council's Statement of Licensing Policy. It is considered that the following paragraphs have a bearing upon the application:

Paragraph 2.0 – Licensing objectives

Paragraphs 8.12 to 8.15 – Prevention of nuisance

Paragraph 9.0 to 9.2 – Complaints against licensed premises

Paragraph 11.19 Licence reviews

Members will have the opportunity to discuss these and any other policies which they or any of the parties consider are relevant at the hearing.

6. STATUTORY GUIDANCE

Members are asked to consider the statutory guidance on the following issues:

Paragraph 5.32 relating to 'interested parties'

Paragraph 5.65 relating to variations to premises licences

Paragraphs 7.41, 7.42 and 7.43 relating to public nuisance

Members will have the opportunity to discuss these and other parts of the guidance, if relevant, with the parties at the hearing.

7. OTHER RELEVANT CONSIDERATIONS

7.1 Section 17(1) of the Crime and Disorder Act 1998

Section 17(1) of the Crime and Disorder Act 1998 provides that "without prejudice to any other obligation imposed on it, it shall be the duty of each authority to which this section applies to exercise its various functions with due regard to the likely effect of the exercise of those functions on, and the need to do all it reasonably can to prevent, crime and disorder in its area". This duty applies to the Council in determining the application and, therefore, needs to be put in the balancing exercise together with all the other relevant considerations.

7.2 Human Rights

Under Article 8 of the European Convention on Human Rights the 'interested parties' have a right to respect for their private and family life and their home. They are entitled therefore not to be disturbed by unreasonable noise and nuisance. However, this is a qualified right and has to be balanced against the rights of others including the rights of businesses in the area to operate.

Having regard to the facts of this particular case, Members need to consider whether the objections are sufficiently serious to justify rejecting the application.

8. OBSERVATIONS

- 8.1 Members are reminded that whenever they make a decision under the Licensing Act 2003, they have a **duty** to act with a view to promoting the licensing objectives. These are: the prevention of crime and disorder; public safety; the prevention of public nuisance; and the protection of children from harm.
- 8.2 In making its decision, Members must also have regard to statutory guidance issued under section 182 of the Licensing Act 2003 and the Council's own Licensing Policy. If Members depart from either, they must specify their reasons for doing so. Of course, Members must also have regard to all the representations made and the evidence it hears.
- 8.3 The Sub-Committee must take such of the following steps as it considers necessary for the promotion of the licensing objectives:
1. Grant the licence in accordance with the application.
 2. Modify the conditions of the operating schedule by altering or omitting or adding to them.
 3. Exclude from the scope of the licence any of the licensable activities to which the application relates.
 4. Refuse to specify a person in the licence as the premises supervisor.
 5. Reject the whole of the application.

The Sub-Committee may also grant the licence subject to different conditions for different parts of the premises or the different licensable activities.

- 8.4 Members are asked to note that they may not modify the conditions or reject the whole or part of the application merely because they consider it desirable to do so. It must actually be **necessary** to do so in order to promote the licensing objectives and any such step must relate to the actual representations made.
- 8.5 If Members grant the application, the details of the operating schedule (as set out in page 23 of Appendix 1) will be incorporated into the licence as conditions. The licence will also be subject to certain mandatory conditions.

9 ISSUES RAISED BY THE APPLICATION

- 9.1 To date the Queens Head has not been a cause for complaint either in respect to noise or crime and disturbance and there is no evidence of any such problems.
- 9.2 The 'interested parties' are basing their representations on the potential impact that the conversion will have on their enjoyment of their property. This concern appears to relate to the provision of music at the premises and the likelihood of

- noise transmission through the structure and subsequent disturbance to the occupiers.
- 9.3 Mr Kavan has sketched a diagram in his letter indicating the proximity of his 'living room' to where he believes performances of karaoke will take place. The applicant however indicates in the operating schedule that performances will take place 'in the back bar away from nearby housing'. The premises licence may restrict the provision of entertainment to a specific part of the premises, such as the back room. It is difficult to assess the success of this particular control measure. However Environmental Health have not made a representation and so the presumption is that they believe that such a restriction would be satisfactory.
- 9.4 Miss McKernion's comments regarding the 'potential sales of the property in the future' is not a relevant consideration as it does not fall within the scope of any of the four licensing objectives.
- 9.5 In an attempt to assist Members assess the impact of the Swan on the 'interested parties' attached as Appendix 4 is a location plan showing the relevant premises.
- 9.6 On the facts of this particular application and in light of the representations made, if Members are minded to grant the application the following additional conditions might be appropriate:
- Entertainment shall be held within the back room only and no music or loudspeakers shall be provided in any other part of the premises and to external areas of the premises.
 - A noise limiter shall be fitted to the musical amplification system in agreement with and to the satisfaction of an authorised officer of the responsible environmental health authority. The noise limiter shall be set and maintained at a level to be decided upon by the said officer.
 - In order to maintain the acoustic integrity of the premises during the provision of regulated entertainment, a detailed technical specification of the sound insulation measures to be used shall be submitted to and agreed by Environmental Health and shall be implemented prior to the provision of the regulated entertainment.

At the hearing Members should invite the parties to discuss these and any other conditions the Sub-Committee and the parties themselves propose.

Ultimately, however, these issues are for the Sub-Committee to determine having regard to all the relevant considerations. Whatever the Sub-Committee decides, it must give reasons.

(Part A) Application for an existing licence to be converted to a premises licence under the Licensing Act 2003 and (Part B) application to vary the premises licence simultaneously

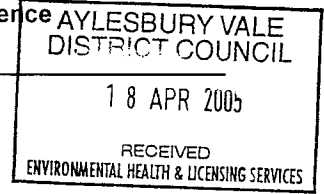

PLEASE READ THE FOLLOWING INSTRUCTIONS FIRST

Before completing this form please read the guidance notes at the end of the form. If you are completing this form by hand please write legibly in block capitals. In all cases ensure that your answers are inside the boxes and written in black ink. Use additional sheets if necessary. You may wish to keep a copy of the completed form for your records.

We Punch Taverns Plc apply to convert an existing licence to a premises licence under Schedule 8 to the Licensing Act 2003 for the premises described in Part A1 below

Part A1 - Premises Details

Postal address of premises if any or, if none, ordnance survey map reference or description	
Queens Head 9 High Street Wing	
Post town	Post code
Leighton Buzzard	LU7 0NS

Telephone number of premises (if any)	01296 688268
Non-domestic rateable value of premises	£ 7,800.00

Part A2 - Applicant Details

Please state the capacity in which you are applying to convert your existing licence

Please tick ✓

- a) An individual or individuals please complete section (A)
- b) a person other than an individual
 - i. as a limited company please complete section (B)
 - ii. as a partnership please complete section (B)
 - iii. as an unincorporated association or please complete section (B)
 - iv. other (for example a statutory corporation) please complete section (B)
- c) a recognised club please complete section (B)
- d) a charity please complete section (B)
- e) the proprietor of an educational establishment please complete section (B)
- f) a health service body please complete section (B)

- g) a person who is registered under Part 2 of the Care Standards Act 2000 (c14) in respect of an independent hospital
- k) the chief officer of police of a police force in England and Wales

please complete section (B)

please complete section (B)

(A) INDIVIDUAL APPLICANTS (fill in as applicable)

Mr Mrs Miss Ms Other title (for example, Rev)

Surname

First names

Please tick

I am 18 years old or over

Yes

Current postal address if different from premises address

Post Town

Postcode

Daytime contact telephone number

E-mail address (optional)

SECOND INDIVIDUAL APPLICANT IF APPLICABLE

Mr Mrs Miss Ms Other title (for example, Rev)

Surname

First names

Please tick

I am 18 years old or over

Yes

Current postal address if different from premises address

Post Town

Postcode

Daytime contact telephone number

E-mail address (optional)

(B) OTHER APPLICANTS

Please provide name and registered address of applicant in full. Where appropriate please give any registered number. In case of a partnership or other joint nature (other than a body corporate), please give the name and address of each party concerned.

Name	Punch Taverns Plc
Address	Jubilee House Second Avenue Burton Upon Trent Staffordshire DE14 2WF
Registered number (where applicable)	03752645
Description of applicant (for example, partnership, company, unincorporated association etc.)	Company
Telephone number (if any)	01283 501 600
E-mail address (Optional)	n/a

Part A3 Operating Schedule

If 5,000 or more people attend the premises at any one time, please state the number

n/a

General description of premises (please read guidance note 1)

A mid market local public house located in the centre of the village of Wing serving both food and drink. 2 trade bars and outside patio and garden for consumption of food and drink.

Please tick Yes

What existing licensable activities are authorised by your existing licence(s)?

Provision of regulated entertainment

- a) plays
- b) films
- c) indoor sporting events
- d) boxing or wrestling entertainment
- e) live music
- f) recorded music
- g) performances of dance
- h) anything of a similar description to that falling within (e), (f) or (g)

Provision of entertainment facilities for:

- i) making music
- j) dancing
- k) entertainment of a similar description to that falling within (i) or (j)

Provision of late night refreshment

Sale by retail of alcohol

- a) for consumption on the premises
- b) for consumption off the premises

Please state who you wish to be specified to be the premises supervisor under the new licence

Name Denise Joy Redding

Address Queens Head, 9 High Street, Wing, Leighton Buzzard, LU7 0NS

Personal Licence number, if known

State any limitations on the hours during which you are permitted by your licence(s) or any additional authorities to conduct licensable activities, including the sale of alcohol.

11:00 to 23:00 Monday to Saturday (inc)
12:00 to 22:30 Sunday

save

11:00 to 00:00 New Years Eve (31.12)
00:00 to 23:00 New Years Day (01.01)
12:00 to 15:00 and
19:00 to 22:30 Christmas Day (25.12)

Describe the conditions subject to which your existing licence(s) has/have been granted (please read guidance note 2):

a) General - all four licensing objectives (b,c,d,e)

20 minutes "drinking up" time
All embedded permissions and restrictions attaching to a justices on licence.

b) The prevention of crime and disorder

See a above

c) Public safety

See a above

d) The prevention of public nuisance

See a above

e) The protection of children from harm

See a above

- I have made or enclosed payment of the fee
- I have enclosed my existing licence(s) or a certified copy of each licence
- I have enclosed a plan of the premises
- I have sent copies of this application to the Chief Officer of Police (please read guidance note 3)
- I have enclosed the consent form completed by the proposed premises supervisor, if relevant
- I have enclosed the consent of the justices' licence holder to my application, if relevant
- I understand that if I do not comply with the above requirements my application will be rejected

IT IS AN OFFENCE, LIABLE ON CONVICTION TO A FINE UP TO LEVEL 5 ON THE STANDARD SCALE, UNDER SECTION 158 OF THE LICENSING ACT 2003 TO MAKE A FALSE STATEMENT IN OR IN CONNECTION WITH THIS APPLICATION

Part A5 - Signatures (please read guidance note 4)

Signature of applicant or applicant's solicitor or other duly authorised agent. (please read guidance note 5). If signing on behalf of the applicant please state in what capacity.

Signature

Date

Capacity Solicitors to applicant

[Handwritten signature] *[Handwritten initials]* TLT
13/4/05

For joint applications signature of 2nd applicant or 2nd applicant's solicitor or other authorised agent. (Please read guidance note 6). If signing on behalf of the applicant please state in what capacity.

Signature

Date

Capacity

Contact name (Where not previously given) and address for correspondence associated with this application (Please read guidance note 7) TLT Solicitors One Redcliff Street (Ref: 30PG3/054004/P Smith/591405)	
Post town BRISTOL	Post code BS1 6TP
Telephone number 0117 917 7777	
E-mail address (optional) psmith@TLTsolicitors.com	

IF YOU WISH TO APPLY SIMULTANEOUSLY FOR A VARIATION OF THE PREMISES LICENCE IF IT IS CONVERTED FROM YOUR EXISTING LICENCE(S) UNDER SECTION 34 OR 37 OF THE LICENSING ACT 2003, NOW COMPLETE PART B OF THIS FORM

IF YOU DO NOT WISH TO APPLY SIMULTANEOUSLY FOR A VARIATION OF THE PREMISES LICENCE IF IT IS CONVERTED FROM YOUR EXISTING LICENCE(S), YOU SHOULD LEAVE PART B BLANK

PART B - Application to vary a premises licence under the Licensing Act 2003

We Punch Taverns Plc being the proposed premises licence holder of an existing licence to be converted under the terms of Schedule 8 to the Licensing Act 2003 apply to vary it under section 34/section 37 of the Licensing Act 2003 (delete as applicable) for the premises described in Part A above.

Part B1 - Variation

Please tick ✓

Do you want the proposed variation to have effect from the second appointed day?

If not when do you want the variation to take effect from

Day		Month		Year	

If your proposed variation would mean that 5,000 or more people are expected to attend the premises at any one time, please state the number expected to attend

n/a

Please describe briefly the nature of the proposed variation. (please read guidance note 8)

- An additional hour in the evening every Sunday, Monday, Tuesday, Wednesday, Thursday, Friday and Saturday.
- To open an additional hour earlier every Sunday, Monday, Tuesday, Wednesday, Thursday, Friday and Saturday.
- A further additional hour into the morning following every Friday, Saturday, Sunday and Monday for each May Bank Holiday, Spring/Whitsun Bank Holiday and every August Bank Holiday weekend.
- A further additional hour into the morning following every Thursday, Friday, Saturday, Sunday and Monday for the Easter Bank Holiday weekend.
- A further additional hour every Christmas Eve.
- A further additional hour every Boxing Day.
- To reflect existing New Year's Eve/Day hours.
- Drinking up time: an additional 10 minutes, to allow 30 minutes drinking up time, after the last permitted sale of alcohol.

All of the above to be for the sale of alcohol, karaoke, live music with no more than 2 performers and recorded music.

Part B2 - Operating Schedule

Please complete those parts of the operating schedule which would be subject to change if this application to vary was successful.

What licensable activities do you now intend to conduct on the premises and/or at what varied times do you intend to conduct them?

(Please see section 1 of the Licensing Act 2003 and Schedule 1 to the Licensing Act 2003)

	<u>Please tick</u> ✓
<u>Provision of regulated entertainment</u>	Yes
a) plays (if ticking yes, fill in box A)	<input type="checkbox"/>
b) films (if ticking yes, fill in box B)	<input type="checkbox"/>
c) indoor sporting events (if ticking yes, fill in box C)	<input type="checkbox"/>
d) boxing or wrestling entertainment (if ticking yes, fill in box D)	<input type="checkbox"/>
e) live music (if ticking yes, fill in box E)	<input checked="" type="checkbox"/>
f) recorded music (if ticking yes, fill in box F)	<input checked="" type="checkbox"/>
g) performances of dance (if ticking yes, fill in box G)	<input type="checkbox"/>
h) anything of a similar description to that falling within (e),(f) or (g) (if ticking yes, fill in box H)	<input type="checkbox"/>
<u>Provision of entertainment facilities</u>	
i) making music (if ticking yes, fill in box I)	<input type="checkbox"/>
j) dancing (if ticking yes, fill in box J)	<input type="checkbox"/>
k) entertainment of a similar description to that falling within (i) or (j) (if ticking yes, fill in box K)	<input checked="" type="checkbox"/>
<u>Provision of late night refreshment</u> (if ticking yes, fill in box L)	<input type="checkbox"/>
<u>Sale by retail of alcohol</u> (if ticking yes, fill in box M)	<input checked="" type="checkbox"/>

Please complete Part B3 on this form.

A

Plays Standard days and timings (please read guidance note 8)			Will the performance of a play take place indoors or outdoors or both - please tick [✓] (please read guidance note 9)	Indoors	
				Outdoors	
Day	Start	Finish		Both	
Mon			Please give further details here (please read guidance note 10)		
Tue					
Wed			State any seasonal variations for performing plays (please read guidance note 11)		
Thur					
Fri			Non standard timings. Where you intend to use the premises for the performance of plays at different times to those listed in the column on the left, please list (please read guidance note 12)		
Sat					
Sun					

B

Films Standard days and timings (please read guidance note 8)			Will the exhibition of films take place indoors or outdoors or both - please tick [√] (please read guidance note 9)	Indoors	
				Outdoors	
Day	Start	Finish		Both	
Mon			Please give further details here (please read guidance note 10)		
Tue					
Wed			State any seasonal variations for the exhibition of films (please read guidance note 11)		
Thur					
Fri			Non standard timings. Where you intend to use the premises for the exhibition of films at different times to those listed in the column on the left, please list (please read guidance note 12)		
Sat					
Sun					

C

Indoor sporting events			Please give further details here (please read guidance note 10)
Day	Start	Finish	
Mon			<p><u>State any seasonal variations for indoor sporting events</u> (please read guidance note 11)</p> <p><u>Non standard timings. Where you intend to use the premises for indoor sporting events at different times to those listed in the column on the left, please list</u> (please read guidance note 12)</p>
Tue			
Wed			
Thur			
Fri			
Sat			
Sun			

D

Boxing or wrestling entertainment Standard days and timings (please read guidance note 8)			Will the boxing or wrestling entertainment take place indoors or outdoors or both - please tick [✓] (please read guidance note 9)	
			Indoors	
			Outdoors	
			Both	
Day	Start	Finish	Please give further details here (please read guidance note 10)	
Mon				
Tue			State any seasonal variations for boxing or wrestling entertainment (please read guidance note 11)	
Wed				
Thur			Non standard timings. Where you intend to use the premises for boxing or wrestling entertainment at different times to those listed in the column on the left, please list (please read guidance note 12)	
Fri				
Sat				
Sun				

E

Live music Standard days and timings (please read guidance note 8)			Will the performance of live music take place indoors or outdoors or both - please tick [√] (please read guidance note 9)		Indoors	✓
					Outdoors	
					Both	
Day	Start	Finish	Please give further details here (please read guidance note 10)			
Mon	10:00	00:00	Amplified live music limited to 2 entertainers on a monthly basis.			
Tue	10:00	00:00				
Wed	10:00	00:00	State any seasonal variations for the performance of live music (please read guidance note 11)			
Thur	10:00	00:00				
Fri	10:00	00:00	Non standard timings. Where you intend to use the premises for the performance of live music at different times to those listed in the column on the left, please list (Please read guidance note 12)			
Sat	10:00	00:00	<ul style="list-style-type: none"> • A further additional hour into the morning following every Friday, Saturday, Sunday and Monday for each May Bank Holiday, Spring/Whitsun Bank Holiday and every August Bank Holiday weekend. • A further additional hour into the morning following every Thursday, Friday, Saturday, Sunday and Monday for the Easter Bank Holiday weekend. • A further additional hour every Christmas Eve. • A further additional hour every Boxing Day. • To reflect existing New Year's Eve/Day hours. 			
Sun	11:00	23:30				

F

Recorded music Standard days and timings (please read guidance note 8)			Will the playing of recorded music take place indoors or outdoors or both - please tick [✓] (please read guidance note 9)		Indoors	✓
					Outdoors	
					Both	
Day	Start	Finish	Please give further details here (please read guidance note 10) To match sale of liquor at section M below. Amplified recorded music ancillary to sale of alcohol (section M) below.			
Mon	10:00	00:00				
Tue	10:00	00:00				
Wed	10:00	00:00	State any seasonal variations for playing recorded music (please read guidance note 11) 			
Thur	10:00	00:00				
Fri	10:00	00:00	Non standard timings. Where you intend to use the premises for the playing of recorded music at different times to those listed in the column on the left, please list (Please read guidance note 12) <ul style="list-style-type: none"> • A further additional hour into the morning following every Friday, Saturday, Sunday and Monday for each May Bank Holiday, Spring/Whitsun Bank Holiday and every August Bank Holiday weekend. • A further additional hour into the morning following every Thursday, Friday, Saturday, Sunday and Monday for the Easter Bank Holiday weekend. • A further additional hour every Christmas Eve. • A further additional hour every Boxing Day. • To reflect existing New Year's Eve/Day hours. 			
Sat	10:00	00:00				
Sun	11:00	23:30				

G

Performances of dance Standard days and timings (please read guidance note 8)			Will the performance of dance take place indoors or outdoors or both - please tick [√] (please read guidance note 9)		Indoors	
					Outdoors	
					Both	
Day	Start	Finish	Please give further details here (please read guidance note 10)			
Mon						
Tue			State any seasonal variations for the performance of dance (please read guidance note 11)			
Wed						
Thur						
Fri			Non standard timings. Where you intend to use the premises for the performance of dance entertainment at different times to those listed in the column on the left, please list (please read guidance note 12)			
Sat						
Sun						

H

Anything of a similar description to that falling within (e), (f) or (g) Standard days and timings (please read guidance note 8)			Please give a description of the type of entertainment you will be providing			
			Will this entertainment take place indoors or outdoors or both - please tick [√] (please read guidance note 9)		Indoor	
Outdoor						
Day	Start	Finish	Please give further details here (please read guidance note 10)			
Mon						
Tue			State any seasonal variations for entertainment of a similar description to that falling within (e), (f) or (g) (please read guidance note 11)			
Wed						
Thur						
Fri			Non standard timings. Where you intend to use the premises for the entertainment of a similar description to that falling within (e), (f) or (g) at different times to those listed in the column on the left, please list (please read guidance note 12)			
Sat						
Sun						

1

Provision of facilities for making music Standard days and timings (please read guidance note 8)			Please give a description of the facilities for making music you will be providing			
			Will the facilities for making music take place indoors or outdoors or both - please tick [✓] (please read guidance note 9)		Indoor	
					Outdoor	
					Both	
Day	Start	Finish	Please give further details here (please read guidance note 10)			
Mon						
Tue						
Wed			State any seasonal variations for the provision of facilities for making music (please read guidance note 11)			
Thur						
Fri						
			Non standard timings. Where you intend to use the premises for provision of facilities for making music entertainment at different times to those listed in the column on the left, please list (please read guidance note 12)			
Sat						
Sun						

J

Provision of facilities for dancing			Will the facilities for dancing be indoors or outdoors or both - please tick [✓] (please read guidance note 9)	Indoors	
Standard days and timings (please read guidance note 8)				Outdoors	
Day	Start	Finish	Both		
Mon			<u>Please give further details here</u> (please read guidance note 10)		
Tue			<u>State any seasonal variations for providing dancing facilities</u> (please read guidance note 11)		
Wed			<u>Non standard timings. Where you intend to use the premises for the provision of facilities for dancing entertainment at different times to those listed in the column on the left, please list</u> (please read guidance note 12)		
Thur					
Fri					
Sat					
Sun					

K

Provision of facilities for entertainment of a similar description to that falling within i or j Standard days and timings (please read guidance note 8)			Please give a description of the type of entertainment facility you will be providing Karaoke		
Day	Start	Finish	Will the entertainment facility be indoors or outdoors or both . please tick [✓] (please read guidance note 9)	Indoor	✓
				Outdoor	
Mon	10:00	00:00		Both	
Tue	10:00	00:00	Please give further details here (please read guidance note 10)		
Wed	10:00	00:00			
Thur	10:00	00:00	State any seasonal variations for the provision of facilities for entertainment of a similar description to that falling within i or j (please read guidance note 11)		
Fri	10:00	00:00			
Sat	10:00	00:00	Non standard timings. Where you intend to use the premises for the provision of facilities for entertainment of a similar description to that falling within i or j at different times to those listed in the column on the left, please list (please read guidance note 12)		
Sun	11:00	23:30			
			<ul style="list-style-type: none"> • A further additional hour into the morning following every Friday, Saturday, Sunday and Monday for each May Bank Holiday, Spring/Whitsun Bank Holiday and every August Bank Holiday weekend. • A further additional hour into the morning following every Thursday, Friday, Saturday, Sunday and Monday for the Easter Bank Holiday weekend. • A further additional hour every Christmas Eve. • A further additional hour every Boxing Day. • To reflect existing New Year's Eve/Day hours. 		

L

Late night refreshment Standard days and timings (please read guidance note 8)			Will the provision of late night refreshment take place indoors or outdoors or both - please tick [✓] (please read guidance note 9)	Indoors	
				Outdoors	
Day	Start	Finish		Both	
Mon			<u>Please give further details here</u> (please read guidance note 10)		
Tue					
Wed			<u>State any seasonal variations for the provision of late night refreshment</u> (please read guidance note 11)		
Thur					
Fri			<u>Non standard timings. Where you intend to use the premises for the provision of late night entertainment at different times, to those listed in the column on the left, please list</u> (please read guidance note 12)		
Sat					
Sun					

M

Supply of alcohol Standard days and timings (please read guidance note 8)			Will the sale of alcohol be for consumption please tick [✓] (please read guidance note 13)	On the premises	
				Off the premises	
Day	Start	Finish		Both	✓
Mon	10:00	00:00	State any seasonal variations for the supply of alcohol (please read guidance note 11)		
Tue	10:00	00:00			
Wed	10:00	00:00	Non standard timings. Where you intend to use the premises for the supply of alcohol at different times to those listed in the column on the left, please list (please read guidance note 12) <ul style="list-style-type: none"> • A further additional hour into the morning following every Friday, Saturday, Sunday and Monday for each May Bank Holiday, Spring/Whitsun Bank Holiday and every August Bank Holiday weekend. • A further additional hour into the morning following every Thursday, Friday, Saturday, Sunday and Monday for the Easter Bank Holiday weekend. • A further additional hour every Christmas Eve. • A further additional hour every Boxing Day. • To reflect existing New Year's Eve/Day hours. 		
Thur	10:00	00:00			
Fri	10:00	00:00			
Sat	10:00	00:00			
Sun	11:00	23:30			

IN ALL CASES PLEASE COMPLETE BOXES N, O, P and Q below

N

<p>Please highlight any adult entertainment or services, activities, other entertainment or matters ancillary to the use of the premises that may give rise to concern in respect of children (please read guidance note 14)</p> <p>One AWP machines. One Cigarette machines. No children in bar after 21:00.</p>

O

Hours premises are open to the public			State any seasonal variation (please read guidance note 11)
Standard days and timings (please read guidance note 8)			
Day	Start	Finish	
Mon	10:00		<p>Non standard timings. Where you intend to use the premises to be open to the public at different times from those listed in the column on the left, please list (please read guidance note 12)</p> <ul style="list-style-type: none"> • A further additional hour into the morning following every Friday, Saturday, Sunday and Monday for each May Bank Holiday, Spring/Whitsun Bank Holiday and every August Bank Holiday weekend. • A further additional hour into the morning following every Thursday, Friday, Saturday, Sunday and Monday for the Easter Bank Holiday weekend. • A further additional hour every Christmas Eve. • A further additional hour every Boxing Day. • To reflect existing New Year's Eve/Day hours.
Tue		00:30	
	10:00		
Wed		00:30	
	10:00		
Thur		00:30	
	10:00		
Fri		00:30	
	10:00		
Sat		00:30	
	10:00		
Sun		00:30	
	11:00	00:00	

P

Please identify any of the conditions, terms or restrictions currently imposed on the converted licence which you believe could be removed as a consequence of the proposed variation you are seeking

None

Q Please describe any proposed additional steps that you intend to take in order to promote the four licensing objectives if the proposed variation is granted:

a) General - all four licensing objectives (b,c,d,e) (please read guidance note 15)

Following an assessment of the premises and its surrounding area the following is proposed:
30 minute "drinking up" time will allow appropriate dispersal, use of lavatories etc
In order to further the licensing objectives the licensee reserves the right to move the fire appliances, AWP machines, cigarette machines and or any other similar objects temporarily in a fixed location which may impact on the ability of individuals on the premises to use exits or escape routes without impediment.

b) The prevention of crime and disorder

The car park is well illuminated, as are all exterior areas.
The pub is a member of the local Pub Watch scheme.
Most customers come from the village.

c) Public safety

Emergency lights have been installed in lounge bar.
Food hygiene certificates for food operations staff.
Fire fighting equipment.
Non smoking lounge.

d) The prevention of public nuisance

Amplified music is an occasional occurrence (monthly) and when on is performed in the back bar away from nearby housing and all doors and windows are kept closed.
Staff are trained to request customers to leave quietly and most customers are local.
Signage has been put in place requesting customers to leave quietly.

e) The protection of children from harm

No unaccompanied children allowed on premise.
A non smoking lounge bar, free from AWP machines is available.
Children are not allowed at the bar or near the AWP machine (which is located next to the bar).
All children have to vacate the premises by 21:00.

PART B3 - Premises Supervisor

Full name of proposed designated premises supervisor

Denise Joy Redding

Address of proposed designated premises supervisor

Queens Head, 9 High Street, Wing, Leighton Buzzard. LU7 0NS

Personal licence number of proposed designated premises supervisor, if any, and issuing authority of the personal licence, if applicable

Please tick ✓ Yes

- I enclose the consent form completed by the proposed premises supervisor
- I will give a copy of Part B3 of this application to the chief office of police (section 37 of the Licensing Act 2003)
- I have sent copies of this application to vary (except Part B3) to responsible authorities and others where applicable (section 34 of the Licensing Act 2003)
- I understand that I must now advertise my application to vary (section 37 of the Licensing Act 2003)
- I understand that if I do not comply with the above requirements my application will be rejected

Part B5 - Signatures (please read guidance note 16)

Signature of applicant (the proposed current premises licence holder) or applicant's solicitor or other duly authorised agent. (See guidance note 17) **If signing on behalf of the applicant please state in what capacity.**

Signature *A. M. Giffi- TLT*

Date *13/4/05*

Capacity Solicitors to applicant

Where the premises licence is jointly held signature of 2nd applicant (the proposed current premises licence holder) or 2nd applicant's solicitor or other authorised agent. (please read guidance note 18) **If signing on behalf of the applicant please state in what capacity.**

Signature

Date

Capacity

Contact name (where not previously given) and address for correspondence associated with this application (please read guidance note 19)	
TLT Solicitors One Redcliff Street (Ref: 30PG3/054004/P Smith/591405)	
Post town BRISTOL	Post code BS1 6TP

Notes for Guidance

PART A

1. Describe the premises. For example the type of premises, it's general situation and layout and any other information which would be relevant to the licensing objectives. Where your application includes off-supplies of alcohol and you provide a place for consumption of these off-supplies you must include a description of where the place is and it's proximity to the premises.
2. Where the conditions to which your existing licence(s) is granted do not relate solely to any one of the four licensing objectives, please describe such conditions in the general box.
3. The law requires you to send a mandatory copy of this application to the chief officer of police for that area at the same time as sending to the relevant licensing authority.
4. The application form must be signed.

5. An applicant's agent (for example solicitor) may sign the form on their behalf provided that they have actual authority to do so.
6. Where there is more than one applicant, both applicants or their respective agents must sign the application form.
7. This is the address we shall use to correspond with you about this application.

PART B

This application cannot be used to vary the licence to vary substantially the premises to which it relates. If you wish to make that type of change to the premises licence you should make a new premises licence application under section 17 of the Licensing Act

8. Please give timings in 24 hour clock and only give details for days of the week when you intend the premises to be used for the activity.
9. Where taking place in a building or other structure please tick as appropriate. Indoors may include a tent.
10. Please state type of activity to be authorised, if not already stated, and give relevant further details, for example (but not exclusively) whether or not music will be amplified or unamplified.
11. For example (but not exclusively), where the activity will occur on additional days during the summer.
12. For example (but not exclusively), where you wish the activity to go on longer on a particular day i.e Christmas Eve.
13. If you wish people to be able to consume alcohol on the premises please tick on, if you wish people to be able to purchase alcohol to consume away from the premises please tick off. If you wish people to be able to do both please tick both.
14. Please give information about anything to occur at the premises or ancillary to the use of the premises which may give rise to concern in respect of children, for example (but not exclusively) nudity or semi-nudity, films for restricted age groups, the presence of gambling machines.
15. Please list here steps you will take to promote all four licensing objectives together.
16. The application form must be signed.
17. A applicant's agent (for example solicitor) may sign the form on their behalf provided that they have actual authority to do so.
18. Where there is more than one applicant, both applicants or their respective agents must sign the application form.
19. This is the address which we shall use to correspond with you about this application.

Form of Consent given by the person whom the applicant wishes to
the premises supervisor

I(1).....DENISE JOY REDDING.....

hereby consent to being named as the premises supervisor in a new licence granted under paragraph 4 of schedule 8 to the Licensing Act 2003 To **Punch Taverns Plc** in respect of the application to convert an existing Justices Licence where the holder of the licence has consented to the application being made by the applicant.

For (2).....THE QUEENS HEAD, 9, HIGH STREET, WING,
LEIGHTON BUZZARD, BEDS, LUTONS.....

If that application is successful

Signed..........

Dated.....22-02-05.....

Notes to Assist Completion

Please use Capital letters and black ink

1. Insert first names and surname of prospective premises supervisor.
2. Insert full name and address of existing licensed premises.



Central Buckinghamshire Magistrates Court

Licensing Act, 1964

TRANSFER OF JUSTICES' 'ON' LICENCE

AT THE LICENSING SESSIONS For the Petty Sessional Area of Central Buckinghamshire

held on the **8th day of November 2004**

The Licensing Justices for the said division hereby grant, by way of transfer, to

Denise Joy Redding

this Justices' 'On' Licence authorising him/her, in substitution for

Darren Smith, Deborah Reynolds

who holds a licence in respect of the premises mentioned below, authorising him/her to sell by retail at the premises situated at

Queens Head, 9 High Street, Wing, Leighton Buzzard, Beds LU7 0NS

intoxicating liquor of all descriptions for consumption either on or off the premises.

The owners of the premises in respect of which this licence is granted are

ALLIED DOMEcq

This licence is granted subject to any conditions/undertakings endorsed on the justices' licence hereby transferred and shall have effect from the date hereof until and including the

4th day of April 2007

**or earlier upon
implementation of
Licensing Act 2003**

GIVEN under the official seal of the Licensing Justices which is hereto affixed under their authority by me,

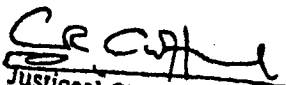
Justices' Chief Executive
Clerk to the Licensing Justices.



I certify that this is a true copy of its original

Andrew Griffin (Solicitor)

Appendix 2

11 High Street
Wing
Leighton Buzzard
LU7 0NS.

16.05.08

Dear Aylesbury Vale Licensing Authority,

It has come to my attention that The Queens Head High Street, Wing, wish to change their licensing agreement to include Karaoke and live music.

I wish to object to this, as I am co-owner of the property next door, and feel that this would seriously affect our homelife, and also potential sales of the property in the future.

This is a quiet village, and we feel that this will disrupt the peace.

Please take this into consideration when making a decision on the application.

Thank you.

Yours sincerely -



Miss Natalie McKernon

Appendix 3

11 High Street
Wing
Leighton Buzzard
Bucks
MK7 0NS

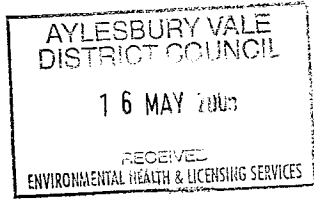

Dear Aylesbury Vale Licensing Authority,

With reference to the change in hours & use for the Queens Head on Wing High Street of Punch breweries. As the neighbour next door to the pub we have no reservations in the change in hours. However how the pub is layed out we are concerned that performances and Karaoke evenings will be a problem. Our living room where we spend most evenings is a-joined to an area of the pub where karaoke & live music could be played. This poses to be a problem if the change of use is granted. We would ask you to take this into consideration. ~~and~~ Below is a diagram of the lay out.

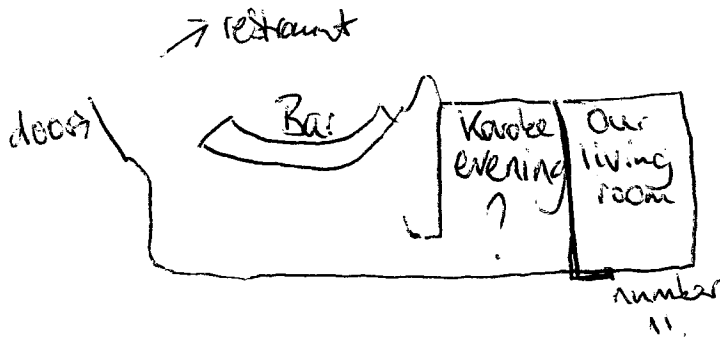

The room next to our house is only where the pub has the room!

We are very concerned at this change in use and would ask you please to consider this.

The Queen's Head

9 High Street, Wing, Bucks LU7 0NS

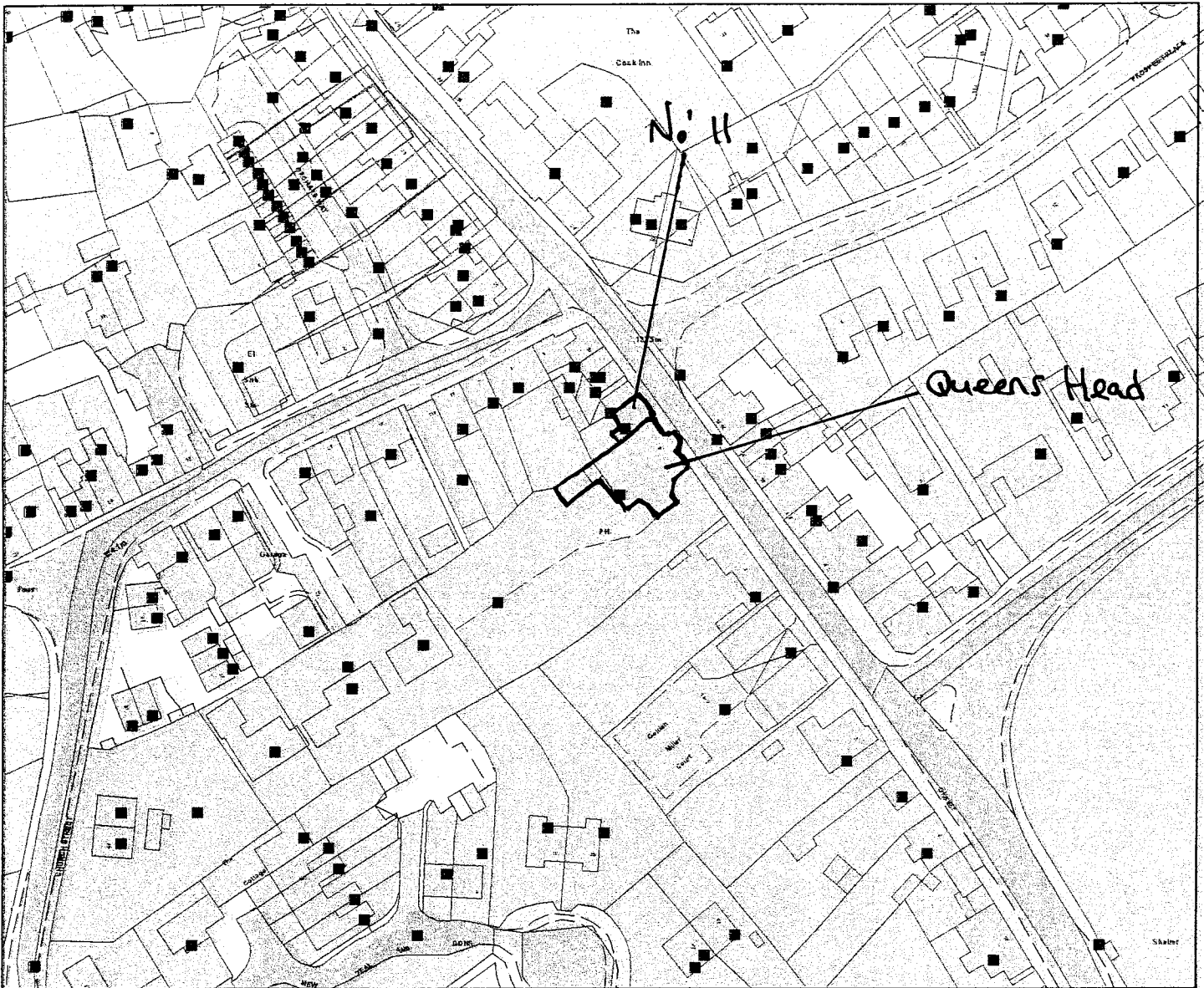

Legend



Reproduced from the Ordnance Survey map with the permission of the Controller of Her Majesty's Stationery Office © Crown Copyright 2000.

Unauthorised reproduction infringes Crown Copyright and may lead to prosecution or civil proceedings.

Organisation	AVDC
Department	Licensing
Comments	05/00343/LAPRE
Date	24 May 2005